



---

BEAUTY  
ESCAPE

---

HOTEL COURTESY SET

*Where luxury meets dreams*



Beauty Escape Made in Italy	3
The collections	4
The fragrances	6
The ingredients	10
The design	12
The commitment for the environment	14
The 400 ml Beauty Escape collections	16
The refill products	70
The 300 ml Beauty Escape collections	90
The accessories	96
Executive tables	98



## *Where luxury meets dreams*

The Beauty Escape amenities line is a sensory journey, an experience that transforms every moment into an opportunity to regenerate and indulge in beauty.

Inspired by understated elegance and the most authentic wellbeing, the line combines advanced cosmetic formulas with refined fragrances, created to celebrate Italian excellence.

Beauty Escape was born in Abano Terme, an iconic location for Italian thermal hospitality and a symbol of timeless wellbeing. An area that has always attracted elite international tourism, drawn by the understated elegance of its atmosphere and its proximity to extraordinary Venice. The line takes shape in this setting, interpreting wellness culture in a contemporary way, with a refined and recognisable style.

---

## *The philosophy of our line*

**Elegant refinement:** products that embody the essence of luxury and attention to detail, just like the prestigious Venetian villa where Beauty Escape was born.

**Care and wellness:** advanced cosmetic formulas, the result of intense and specialised research, combining natural ingredients and innovation to offer a true wellness experience.

**Made in Italy:** a line that celebrates Italian excellence through practical yet refined design, sophisticated aesthetics, constant formulation research, and a deep culture of perfumery.



*The Beauty Escape collections*



**Afrodite**

Golden journey



**Atlantis**

Water bliss



**Artemide**

Nature touch



**Mirage**

Oriental dream



**FLEUR  
DE LIS**

Essence provence



**ACQUA  
DI  
VENEZIA**

Eternal heritage

## *Beauty Escape fragrances: memorable olfactory notes*

Each fragrance tells a story and each texture gently envelops, transforming self-care into a unique, refined and unforgettable experience. They are olfactory compositions designed for an international audience and developed in collaboration with prestigious fragrance houses.

### *Afrodite*

#### **Golden journey**

The Afrodite collection is an ode to sensuality, for a refined and regenerating sensory experience. Its top notes, bright and lively, immediately captivate the senses. The heart and base notes add an enveloping, spicy sweetness, creating a warm and seductive core.



### *Atlantis*

#### **Water bliss**

The fragrance of the Atlantis collection, a vibrant and sophisticated harmony, combines citrus freshness, floral elegance, and musky depth. Its top notes, with an explosion of lemon, grapefruit, and peach, offer a sparkling and sunny opening. The heart and base notes add a touch of delicacy and refinement.



### *Artemide*

#### **Nature touch**

The Artemide collection is dedicated to those seeking a sensory experience in harmony with nature. The fragrance opens with green leaves and blackcurrant for vibrant freshness, the floral heart of freesia and water flowers provides balance, while white musk envelops you in a feeling of elegant and lasting cleanliness.



### *Mirage*

#### **Oriental dream**

The Mirage collection interprets the warmth of amber and the brilliance of citrus in an elegant and magnetic composition. The fragrance opens with a sparkling explosion of bergamot, lime, and orange, enriched by a velvety hint of coconut. At its heart, white flowers and violet meet in a radiant and enveloping accord. The amber base leaves an intense and persistent trail that envelops the senses in a golden embrace.



## *Beauty Escape fragrances: memorable olfactory notes*

### *Fleur de lis*

**Essence provence**

Fleur de Lis offers an olfactory experience inspired by the world of botanicals and the charm of Provence. Its floral fragrance reveals itself with notes of cardamom and rose, evolves into a floral heart of violet, jasmine, and orange blossom, before closing with an enveloping base of patchouli and vanilla in elegant balance.



### *Acqua di Venezia*

**Eternal Heritage**

Inspired by the heritage and cosmopolitanism of Venice, the Acqua di Venezia collection encapsulates the magic of the Serenissima in a sophisticated olfactory pyramid. Its fruity, sweet, and amber fragrance, supported by a warm, woody base, envelops the senses in a refined and memorable experience.



### *Arbory*

The Arbory line, with its floral and fruity notes, offers an enveloping freshness. Violet and white flowers intertwine with a delicate vegetal note and a touch of apple, creating an elegant and refined harmony.



### *Setai*

The Setai line opens with a fresh explosion of aromatic notes, enriched by a touch of lavender and sage. This combination offers an immediate sensation of freshness and elegance, capturing the senses from the very first moment.





## *Premium ingredients for a wellness experience*

The Beauty Escape amenities line has been designed to give you a wellness experience.

All products feature formulations rich in active ingredients that work in synergy to offer the skin intense hydration, soft texture, and radiance.



### *Hyaluronic acid*

It's a high-molecular-weight molecule present in the skin's connective tissue. Thanks to its ability to retain water, it maintains the skin's moisture balance and has marked hydrating, repairing, and tissue-regenerating properties.



### *Glycerine*

A small, plant-derived molecule that retains the skin's moisture, delivering deep, long-lasting hydration and an immediately radiant appearance.



### *Panthenol*

Known as Vitamin B5, it has several important properties for the skin, including hydrating, soothing, and protective properties against irritations.



### *Vitamin E*

It's an active ingredient known for its protection against oxidative damage; it improves hydration, skin elasticity, and accelerates cell renewal processes.

## *Design and functionality: elegance at the service of hospitality*

**The Beauty Escape line combines functional design with refined aesthetics.**

The sinuous and refined bottle has been designed not only to be functional, but also to enrich the bathroom environment of hotel rooms with an elegant and harmonious touch.

This bottle can be used in two ways: resting on the shelf, or fixed to the wall with an elegant bracket. This solution guarantees the inviolability of the bottle, an extra level of security for the hotelier.

---

### *Main features*

**Sustainability:** the refillable bottles reduce single-use plastic.

**Safety:** the bottles secured to the brackets guarantee total inviolability and prevent any possible contamination, for maximum safety.

**Ease of use:** the practical opening system of the brackets allows quick bottle replacement.



## *With Beauty Escape, hospitality is even more environmentally conscious*

Beauty Escape combines elegance and respect for the environment, with solutions designed to reduce the ecological impact of plastic.



### *Refillable bottles*

They reduce single-use plastic and limit product waste, offering hotels a sustainable option.



### *Paper refills*

Predominantly cellulosic, the innovative refills are durable and easy to handle, designed for precise and convenient dosing. They are **FSC**<sup>®</sup> certified for responsible forest management. Additionally, the refills have **Aticelca** certification, which attests to the recyclability of the bottle through paper waste collection, simplifying the recycling process.



### *Ecolabel products*

The line includes references certified with the EU Ecolabel, the official environmental certification of the European Union, such as Artemide in a refillable bottle made from 100% recycled plastic, and Arbory. Collections that combine efficacy and skin care with full respect for the environment, thanks to eco-compatible formulations developed according to strict European standards. A choice that guarantees quality and safety, meeting the needs of a hospitality industry that is increasingly attentive to sustainability.





*Discover the Beauty Escape  
collections: a sensory experience  
that combines luxury and wellness*

Every detail of the Beauty Escape amenities line, from enveloping textures to olfactory notes, is designed to evoke unique emotions.

A cosmetic in a hotel is not just an amenity product: it is the first gesture of the day and the last ritual of the evening.

The Beauty Escape collections include shower gel, hand soap, shampoo, hair & body wash, conditioner, and body lotion, transforming every moment of personal care into an experience of pure refinement and sensory wellbeing.



*and provides operational efficiency  
and sustainability for the hotel*

The **400 ml refillable bottles**, when mounted on the bracket, ensure maximum inviolability. Their ergonomic design facilitates insertion and removal for refilling.

For refilling, Beauty Escape provides bottles in **5-litre** and **1-litre** formats, designed to meet different operational needs.

The **1-litre** refills, in predominantly cellulosic packaging, are ergonomic and easy to handle, easily storable in housekeeping trolleys or in the small service storerooms near the rooms. From a logistical point of view, they optimise palletisation and reduce bulk, while on the environmental front, they help significantly reduce plastic usage and the establishment's carbon footprint.

Each Beauty Escape collection also includes a **coordinated air freshener**, creating an authentic olfactory thread between rooms, fabrics, and common areas. The long-lasting fragrance enhances spaces with elegance and sensory consistency, transforming the stay into a recognisable and memorable experience.





# Atlantis

Water bliss



Atlantis

Water bliss

SHOWER GEL

Made in Italy

Atlantis

Water bliss

BODY LOTION

# Atlantis

## Water bliss

The fragrance of the Atlantis range celebrates vitality and elegance, thanks to the notes of lemon, orange, and lavender, ideal for those seeking a sparkling and energetic sensory experience.



### *Top notes*

An explosion of lemon, grapefruit, and peach, enriched by the freshness of petit grain, offers a sparkling and sunny opening.

### *Heart notes*

The floral heart, with lavender and orange blossom, adds a touch of delicacy and refinement.

### *Base notes*

The musky base envelops with a warm and intoxicating sensation, perfect for those seeking a balance between energy and relaxation.





*Atlantis Shower gel*  
**ATL100**

The moisturising Atlantis shower gel, with vibrant citrus notes, leaves skin energised and deeply hydrated. The formula, enriched with glycerin and hyaluronic acid, nourishes and gives elasticity to the skin. Dermatologically tested, it is suitable for all skin types, even the most sensitive.

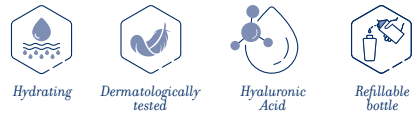

*Atlantis Hand soap*  
**ATL101**

The moisturising Atlantis liquid hand soap, dermatologically tested and pH-neutral, respects the skin, even the most delicate. The formula, enriched with hyaluronic acid and glycerine, cleanses the skin, leaving it soft and energised.



*Atlantis Shampoo*  
**ATL102**

The Atlantis shampoo is enriched with coconut oil, which nourishes the scalp and adds shine to the hair. The gentle formula is suitable for all hair types.



*Atlantis Hair & Body wash*  
**ATL112**

The 2-in-1 Atlantis hair & body wash leaves skin hydrated and energised. It cleanses the hair, adding shine, thanks to its formula with hyaluronic acid and coconut oil extracts. The product is dermatologically tested and suitable even for the most sensitive skin.



*Atlantis Conditioner*  
**ATL103**

The Atlantis conditioner is based on soy proteins, which have a strengthening action on the hair. Its formula is enriched with agents that facilitate hair combing.



*Atlantis Body lotion*  
**ATL104**

The Atlantis body lotion is enriched with almond and sunflower oil, which have an emollient action on the skin. Its formula contains vitamin E, with protective and antioxidant properties.





## *Air freshener*

### *Atlantis Air freshener* **ATLIII**

---

The long-lasting Atlantis air freshener has been developed to deodorise rooms and fabrics and is also suitable for scenting carpets and rugs. A blend of fresh and floral notes with an explosion of Ylang-Ylang and Rose evoke vitality and elegance, for a fresh and refined atmosphere.



Up to 24h



Rooms and fabric



300 ml





# Afrodite

Golden journey



# Afrodite

## Golden journey

The fragrance of the Afro-dite line celebrates the art of seduction, perfect for those seeking a rich, elegant, and memorable ol-factory experience.



### *Top notes*

Bergamot opens the fragrance with a bright and lively citrus note that immediately captures the senses.

### *Heart notes*

At the heart, tonka beans add an enveloping, spicy sweetness, creating a warm and seductive core.

### *Base notes*

The vanilla and musk base envelops with a creamy and sensual softness, leaving an unforgettable scent





*Afrodite Shower gel*  
**AFR100**

The moisturising Afrodite shower gel, with its enveloping and sensual notes, turns the shower into a moment of true wellbeing. Its formula, with moisturising and nourishing properties, gently cleanses the skin, leaving a sensation of softness.



*Afrodite Hand soap*  
**AFR101**

The moisturising Afrodite hand soap, thanks to its formula with hyaluronic acid, known for its elasticising properties, leaves the skin soft and fragrant.



*Afrodite Shampoo*  
**AFR102**

The Afrodite shampoo is enriched with coconut oil, which nourishes the scalp and adds shine to the hair. Its formula is suitable for all hair types.



*Afrodite Hair & Body wash*  
**AFR112**

The 2-in-1 Afrodite hair & body wash cleanses the skin, leaving it soft and hydrated, and gives shine to the hair, thanks to its formula with hyaluronic acid and vanilla extracts. The product is dermatologically tested and suitable even for the most sensitive skin.



*Afrodite Conditioner*  
**AFR103**

The Afrodite conditioner is based on corn proteins, which have a protective action on the hair. Its formula is enriched with agents that help keep hair nourished and full-bodied.



*Afrodite Body lotion*  
**AFR104**

The Afrodite body lotion is enriched with chamomile extract, which has a soothing and gentle action on the skin. Its formula contains Vitamin E, with protective and antioxidant effects.



## *Air freshener*

### *Afrodite Air freshener* **AFR111**

The long-lasting Afroditе air freshener has been designed to deodorise rooms and fabrics, and is also suitable for scenting carpets and rugs. The warm notes of Sandalwood and Patchouli combine with the sensual notes of Geranium and Jasmine, creating a sophisticated and sensual fragrance.



Up to 24h



Rooms and fabric



300 ml

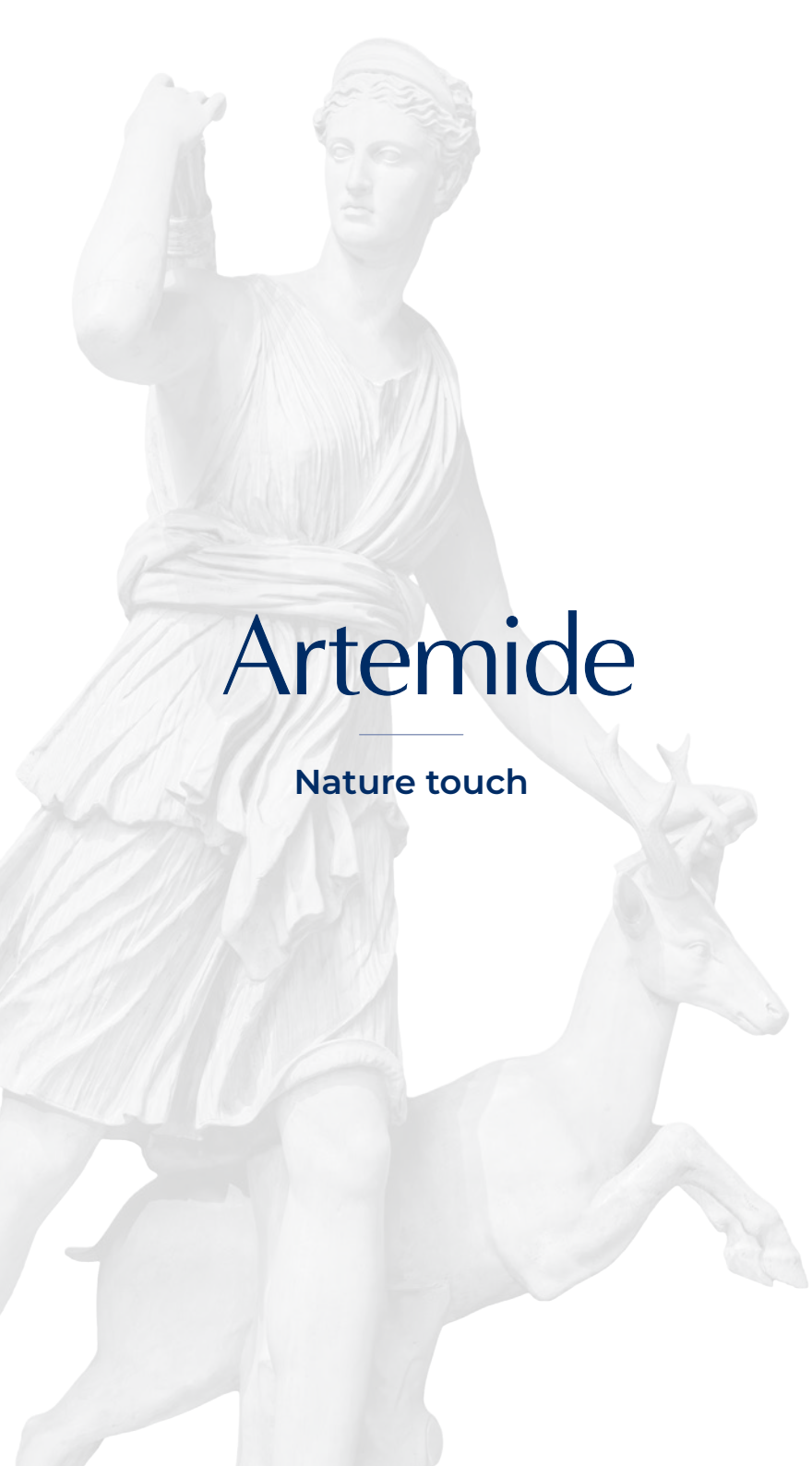

# Artemide

Nature touch



Artemide

Nature touch



SHAMPOO

Made in Italy

Artemide

Nature touch



SHOWER GEL

Made in Italy

Artemide

Nature touch



HAND SOAP

Made in Italy

# Artemide

## Nature touch

Inspired by the goddess of the wild, the Artemide collection evokes the freedom and purity of natural elements, with formulations developed according to Ecolabel standards. Its fragrance celebrates natural harmony, ideal for those seeking a fresh and regenerating olfactory experience.



### Top notes

The green leaves and blackcurrant buds open the fragrance with a lively and natural touch, which evokes the freshness of unspoilt vegetation.

### Heart notes

At the heart, freesia and water flowers release a floral delicacy, symbol of balance and lightness.

### Base notes

White musk closes the composition with a soft, refined veil, leaving a lasting feeling of cleanliness and serenity on the skin.



## *A certified choice for the environment*

The Artemide collection is developed in compliance with the criteria of the EU Ecolabel, the certification that attests to the reduced environmental impact of products throughout their entire life cycle. From selection of raw materials to formulation, from production to packaging (100% recycled plastic), every phase in the creation of the collection meets rigorous environmental and performance standards.

Choosing Artemide means offering guests a sensory experience in harmony with nature and, at the same time, making a concrete and recognisable gesture of environmental responsibility, in line with the ESG objectives and the sustainability policies of hospitality establishments.





*Artemide Shower gel*  
ART100

The Artemide shower gel, enriched with moisturising glycerine and ingredients of natural origin, turns the shower into a moment of pure wellbeing. It gently cleanses the skin, leaving it soft and fragrant thanks to the fresh floral notes of its precious fragrance. Dermatologically tested, it respects the skin. Its formula is environmentally friendly and Ecolabel-certified.



*Artemide Hand soap*  
ART101

The Artemide hand soap, enriched with moisturising glycerine and ingredients of natural origin, turns the shower into a moment of pure wellbeing. It gently cleanses the skin, leaving it soft and fragrant thanks to the fresh floral notes of its precious fragrance. Dermatologically tested, it respects the skin. Its formula is environmentally friendly and Ecolabel-certified.



*Artemide Shampoo*  
ART102

Artemide shampoo gently cleanses and nourishes the scalp, leaving hair hydrated. Its Ecolabel-certified formula is suitable for all hair types, guaranteeing a treatment that respects the skin's balance. The fresh fragrance turns washing into an authentic moment of wellbeing.



*Artemide Hair & Body wash*  
ART112

The 2-in-1 Artemide hair & body wash cleanses skin and hair, adding shine and softness thanks to its gentle formula with glycerine and guar gum derivatives. Dermatologically tested, it is suitable even for the most sensitive skin. Formulation developed following Ecolabel standards.



*Artemide Conditioner*  
ART103

The Artemide conditioner has a formula enriched with wheat proteins, which have volumising properties, leaving hair soft and easy to comb. Developed according to Ecolabel standards.



*Artemide Body lotion*  
ART104

The Artemide Body lotion is enriched with calendula extract and Vitamin E, which have soothing properties. Its delicate, fragrant texture makes application a true ritual of wellbeing and sensory comfort. Formulation developed following Ecolabel standards.





## *Air freshener*

*Artemide Air freshener*  
ARTIII



The Artemide air freshener guarantees a long-lasting, refined fragrance for rooms and fabrics, also perfect for carpets and rugs. The green and fresh notes combine with white musk to create a natural and sophisticated bouquet. Its formulation is **certified A+ Air Label Score Professional**, a guarantee of air quality as it attests to the low emissions of substances released into the air.



Rooms and fabric



300 ml





# Mirage

## Oriental dream

The fragrance of the Mirage collection interprets the warmth of amber and the brilliance of citrus in an elegant and magnetic composition, offering an intense, sophisticated, and luminous sensory experience.



### Top notes

The opening is vibrant, thanks to the sparkling notes of bergamot, lime, and orange, softened by a velvety hint of coconut. A warm and radiant beginning that evokes distant and enveloping atmospheres.

### Heart notes

At the heart, the bouquet of white flowers and violet blends into a soft and refined accord, fragrant with freshness and warmth in an elegant and penetrating balance.

### Base notes

The amber base closes the composition with a warm and persistent trail, intense yet balanced, that envelops the senses in a golden embrace, evoking understated and timeless oriental suggestions.





*Mirage Shower gel*  
**MIR100**

The Mirage shower gel turns the shower into a refined sensory experience. Its moisturising formula with hyaluronic acid cleanses the skin, leaving it soft, while the sparkling notes of bergamot and the heart of white flowers envelop the senses in an elegant and sophisticated bouquet. The amber base leaves a persistent trail, evoking a luminous, oriental atmosphere.



*Mirage Hand soap*  
**MIR101**

The Mirage hand soap is moisturising, with hyaluronic acid, known for its elasticising properties. The skin is left soft and pleasantly scented, while the warm, citrusy fragrance offers an enveloping and elegant sensory experience.



*Mirage Shampoo*  
**MIR102**

The Mirage shampoo is suitable for all hair types and is dermatologically tested. Enriched with hyaluronic acid, it has nourishing properties for the scalp and hair.



*Mirage Hair & Body wash*  
**MIR112**

The 2-in-1 Mirage hair & body wash cleanses the skin, leaving it soft and hydrated, and adds shine to the hair, thanks to its formula with hyaluronic acid. The product is dermatologically tested and suitable even for the most sensitive skin.

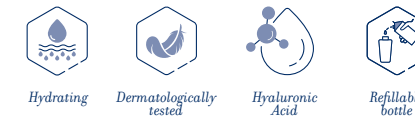

*Mirage Conditioner*  
**MIR103**

The Mirage conditioner is based on corn proteins, which have a protective action on the hair. Its formula is strengthening and enriched with agents that help keep hair nourished and full-bodied.



*Mirage Body lotion*  
**MIR104**

The Mirage body lotion is dermatologically tested and suitable for all skin types. Its formula contains Vitamin E, with protective and antioxidant effects.





## *Air freshener*

### *Mirage Air freshener* MIR111

---

The long-lasting Mirage air freshener has been developed to deodorise rooms and fabrics, and is also suitable for scenting carpets and rugs. The bright, warm notes of citrus and bergamot intertwine with coconut, white flowers, and violet, creating a refined and persistent trail.



Up to 24h



Rooms and fabric



300 ml



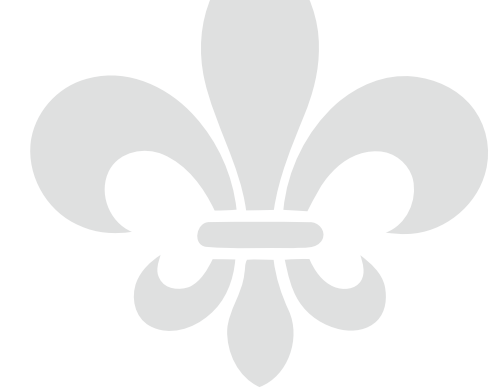

FLEUR  
DE LIS

Essence provence



  
**FLEUR  
DE LIS**

**Essence provence**

With its floral bouquet enriched with notes of vanilla, the Fleur de Lis fragrance offers a refined olfactory experience, inspired by the world of botanicals and the charm of Provence, in an elegant balance.



*Top notes*

The opening releases delicate notes of cardamom, rose, and star anise, creating a refined and luminous beginning, capable of capturing the senses with elegance and lightness.

*Heart notes*

At the heart, violet, jasmine, and orange blossom intertwine in a harmonious and sophisticated bouquet, which envelops the sensory experience with softness and refinement.

*Base notes*

The amber base, enriched with patchouli and vanilla, gives depth and persistence to the fragrance, leaving a warm, enveloping, and timeless trail.





*Fleur de lis Shower gel*  
**FDL100**

The Fleur de Lis shower gel turns the shower into a refined sensory experience. Its moisturising formula with hyaluronic acid gently cleanses the skin, leaving it soft and velvety. The enveloping fragrance accompanies every gesture, while the warm, persistent base leaves an elegant and memorable trail.



*Fleur de lis Hand soap*  
**FDL101**

The Fleur de Lis hand soap combines hydration and gentleness thanks to the hyaluronic acid, which promotes skin elasticity and softness. The warm, enveloping fragrance makes the daily routine of handwashing elegant and sophisticated.



*Fleur de lis Shampoo*  
**FDL102**

The Fleur de Lis shampoo is suitable for all hair types and is dermatologically tested. Enriched with hyaluronic acid, it has nourishing properties for the scalp and hair.



*Fleur de lis Hair & Body wash*  
**FDL112**

The 2-in-1 Fleur de Lis hair & body wash cleanses the skin, leaving it soft and hydrated, and adds shine to the hair, thanks to its formula with hyaluronic acid. The product is dermatologically tested and suitable even for the most sensitive skin.



*Fleur de lis Conditioner*  
**FDL103**

The Fleur de Lis conditioner is based on corn proteins, which have a protective action on the hair. Its formula is strengthening and enriched with agents that help keep hair nourished and full-bodied.



*Fleur de lis Body lotion*  
**FDL104**

The Fleur de Lis body lotion is dermatologically tested and suitable for all skin types. Its formula contains Vitamin E, with protective and antioxidant effects.



## *Air freshener*

### *Fleur de lis Air freshener* FDL111

The Fleur de Lis air freshener is long-lasting and versatile: ideal for deodorising rooms, fabrics, and even carpets or rugs. The fragrance envelops the environment with elegance, leaving a warm, refined, and persistent trail, capable of transforming any space into a sophisticated sensory experience.



Up to 24h



Rooms and fabric



300 ml



# ACQVA DI VENEZIA

Eternal heritage



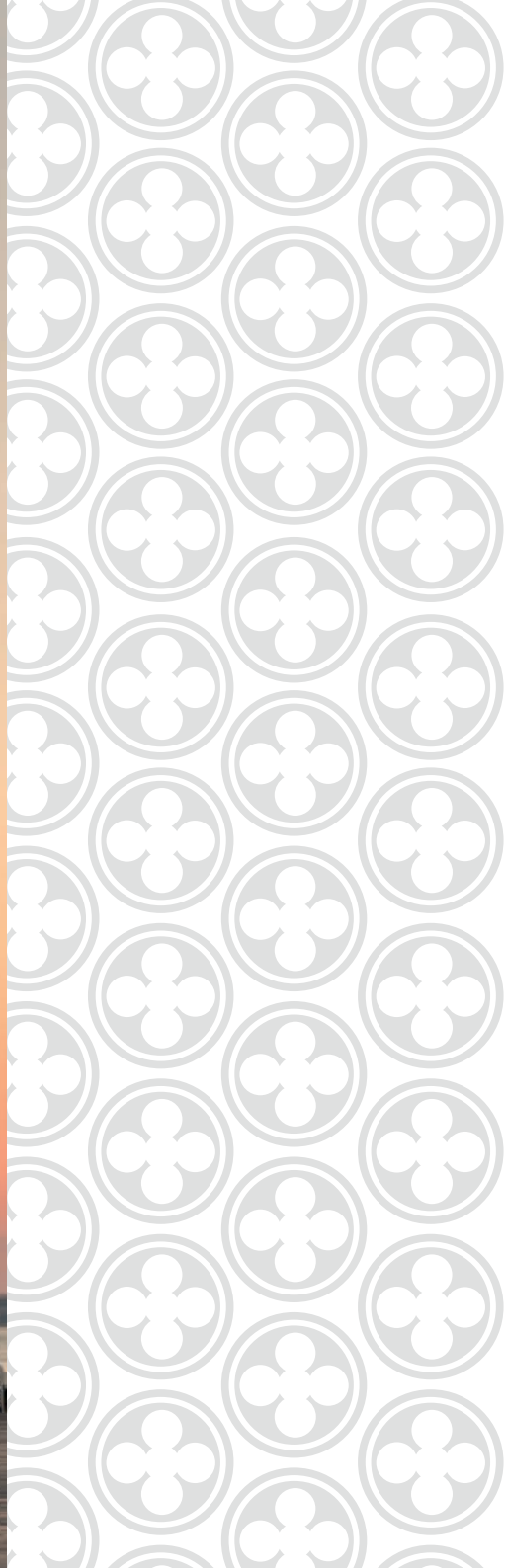

## *Acqua di Venezia*

*Eternal heritage*

**Acqua di Venezia** brings the cosmopolitan charm, beauty, and cultural heritage of the **Serenissima** to premium hotels. The collection transforms every hospitality ritual into a refined experience, evoking elegance, history, and the unique atmosphere of Venice in every detail.

Its visual identity draws inspiration from the city's most iconic symbols: the logo is inspired by the quatrefoil cross of the Doge's Palace, the black-and-gold palette conveys exclusivity and sophistication.

At the heart of the collection lies a sophisticated fragrance—elegant, fruity, sweet, and amber-infused—born from meticulous sensory research.

Luminous, opulent, and enveloping notes create a perfect balance between sensuality and refinement, accompanying guests discreetly and leaving a memorable impression on their stay.

Inspired by the heritage of Venice, the collection celebrates an authentic form of luxury, making stay into an elegant and timeless experience.





**ACQVA  
DI  
VENEZIA**

**Eternal heritage**

The Acqva di Venezia collection encapsulates the magic of the lagoon city in a sophisticated olfactory pyramid. A fruity, sweet, and amber fragrance, supported by a warm, woody base, envelops the senses in a refined and memorable experience.



*Top notes*

The fruity and luminous opening evokes the gentle sparkle of the lagoon waters and the vitality of its canals.

*Heart notes*

The sweet, velvety heart releases milk, peach and caramel, creating an enveloping bouquet that blends softness and warmth in an elegant, sensory balance.

*Base notes*

The sophisticated base develops around patchouli and oriental woods, giving the fragrance an amber and woody character. Persistent and cosmopolitan.





*Acqva di Venezia Shower gel*  
**ADV008**

The Acqva di Venezia shower gel gently cleanses the skin, leaving it soft and velvety. The dermatologically tested formula, enriched with hyaluronic acid and jojoba oil, helps preserve skin hydration. Its elegant fruity and amber notes turn the shower into an experience of sensory wellbeing.



*Acqva di Venezia Hand soap*  
**ADV009**

The Acqva di Venezia hand soap is moisturising, with hyaluronic acid known for its elasticising properties, and jojoba oil. The skin is left soft and pleasantly scented, with a refined bouquet that recalls the cosmopolitan charm of the Serenissima.

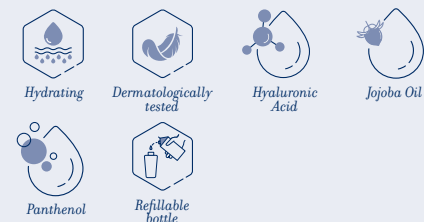

*Acqva di Venezia Shampoo*  
**ADV010**

The Acqva di Venezia shampoo is dermatologically tested and suitable for all hair types. Thanks to its formula enriched with rice starch, it nourishes the scalp and gives volume, elasticity, and shine to the hair. It gently cleanses, leaving the hair soft and pleasantly scented.



*Acqva di Venezia Hair & Body wash*  
**ADV019**

The 2-in-1 Acqva di Venezia hair & body wash gently cleanses skin and hair. The combination of rice starch and hyaluronic acid with moisturising action helps keep the skin soft and nourished, while adding shine to hair. Dermatologically tested and suitable even for the most sensitive skin, it transforms the daily routine into a complete sensory wellbeing experience.

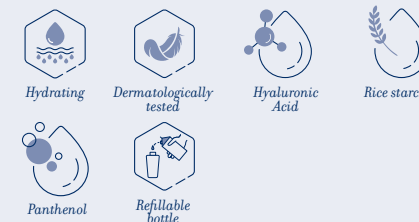

*Acqva di Venezia Body lotion*  
**ADV012**

The Acqva di Venezia body lotion is enriched with panthenol, which has soothing properties, and Vitamin E, with protective and antioxidant effects. The skin is left soft, nourished, and pleasantly scented, for a moment of pure sensory wellbeing.



*Acqva di Venezia Conditioner*  
**ADV011**

The Acqva di Venezia conditioner is based on corn and wheat proteins, which have a strengthening action on the hair. Dermatologically tested, it features a formula enriched with agents that help keep hair nourished and full-bodied.





## *Air freshener*

### *Acqua di Venezia Air freshener* ADV022

The long-lasting Acqua di Venezia air freshener has been designed to deodorise rooms and fabrics, and is also suitable for scenting carpets and rugs. The warm, sensual notes create a refined and persistent trail.



Up to 24h



Rooms and fabric



300 ml



## Cellulose-prevalent refills: sustainable, practical, without product waste

Beauty Escape confirms its commitment to sustainability with refills in predominantly cellulosic material certified **FSC®**, for responsible forest management. Additionally, the refill has **Aticelca** certification, which attests to the recyclability of the bottle through paper waste collection, simplifying the recycling process.

This innovative design not only significantly reduces plastic usage, combining practicality with environmental care, but has also been designed to make things easier for the operator. The refill bottle is sturdy and easy to handle, and thanks to these characteristics, it can be used with just one hand; its shape allows for precise dosing, without product waste.



This packaging which is predominantly cellulose, is FSC-certified



Its recyclability is tested and certified according to UNI 11743:2019



This packaging is durable and facilitates use



Easy to handle



Solid and durable



Precise dosing, facilitates the filling of bottles

1-LITRE REFILLS

Atlantis

Water bliss

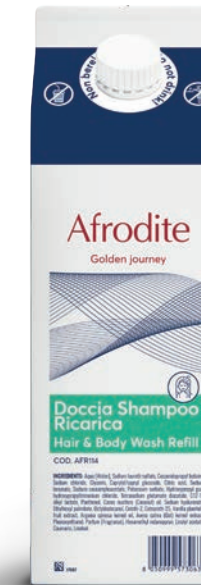
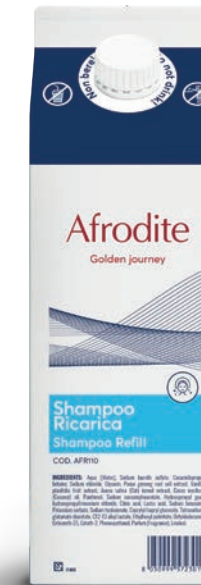
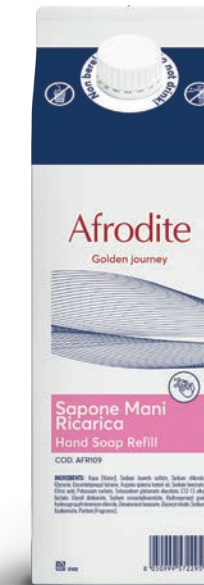
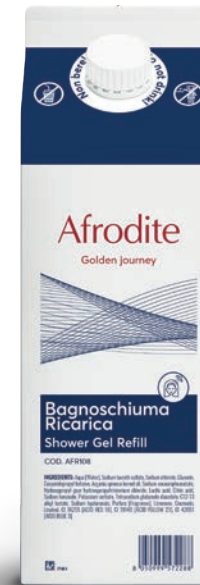
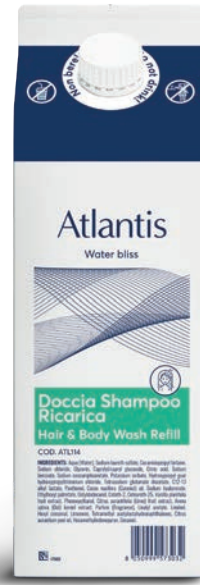
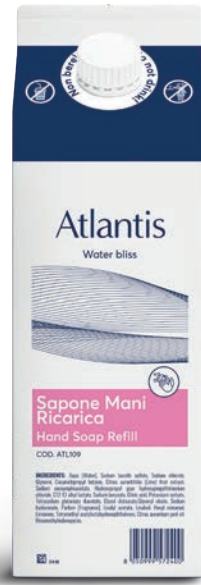
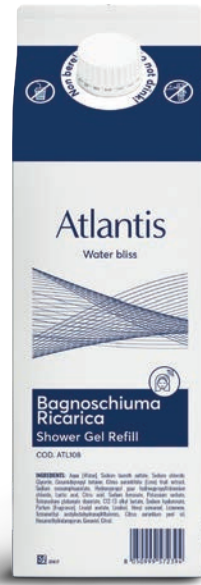

1-LITRE REFILLS

Afrodite

Golden journey

Atlantis Shower gel  
refill box  
ATL108

Atlantis Hand soap  
refill box  
ATL109

Atlantis Shampoo  
refill box  
ATL110

Atlantis Hair & Body  
wash refill box  
ATL114

Afrodite Shower gel  
refill box  
AFR108

Afrodite Hand soap  
refill box  
AFR109

Afrodite Shampoo  
refill box  
AFR110

Afrodite Hair & Body  
wash refill box  
AFR114



1-LITRE REFILLS

Artemide

Nature touch

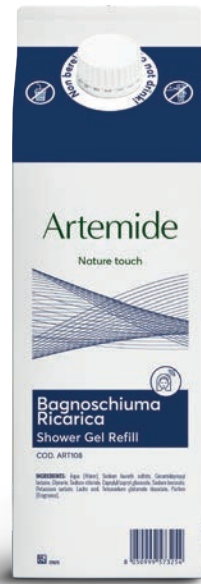

Artemide Shower gel  
refill box  
ART108

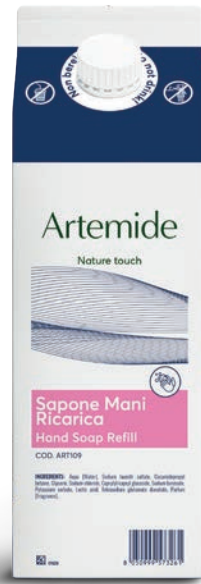

Artemide Hand soap  
refill box  
ART109



Artemide Shampoo  
refill box  
ART110



Artemide Hair & Body  
wash refill box  
ART114



Mirage Shower gel  
refill box  
MIR108



Mirage Hand soap  
refill box  
MIR109



Mirage Shampoo  
refill box  
MIR110



Mirage Hair & Body  
wash refill box  
MIR114



1-LITRE REFILLS

Mirage

Oriental dream



Dermatologically tested



Glycerine



Dermatologically tested



Glycerine



Dermatologically tested



Glycerine



Dermatologically tested



Guar gum



Hydrating



Dermatologically tested



Hyaluronic Acid



Hydrating



Dermatologically tested



Hyaluronic Acid



Hydrating



Dermatologically tested



Hyaluronic Acid



Hydrating



Dermatologically tested



Hyaluronic Acid

1-LITRE REFILLS

*Fleur de lis*

Essence provence



*Fleur de lis Shower gel  
refill box*  
FDL108

*Fleur de lis Hand soap  
refill box*  
FDL109

*Fleur de lis Shampoo  
refill box*  
FDL110

*Fleur de lis Hair & Body  
wash refill box*  
FDL114



Panthenol



Panthenol



Panthenol



Panthenol



ACQVA  
DI  
VENEZIA

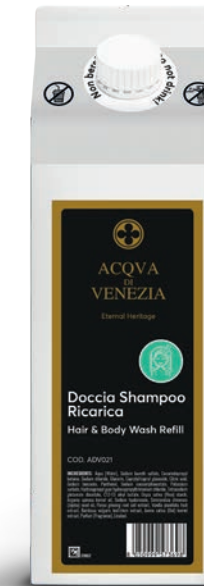
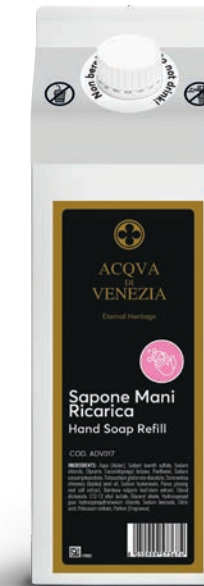

*Acqua di Venezia Shower  
gel refill box*  
ADV016

*Acqua di Venezia Hand  
soap refill box*  
ADV017

*Acqua di Venezia  
Shampoo refill box*  
ADV018

*Ricarica Acqua di Venezia  
Hair & Body wash refill box*  
ADV021



1-LITRE REFILLS

*Acqua di Venezia*

Eternal heritage

## 5-litre refills

The 5-litre container allows the 400 ml bottles to be refilled with the help of the practical dispenser, thus avoiding the need to replace products once they run out, enabling a reduction in plastic waste for the hospitality establishment.



## PRODUCTION BATCH TRACEABILITY

Carry out the refill operation avoiding contamination of the product, in a clean environment, with clean gloves on a clean work surface, respecting the PAO of the refill



Refill the 400 ml bottle by pouring the product from the 5L canister equipped with a dispensing pump

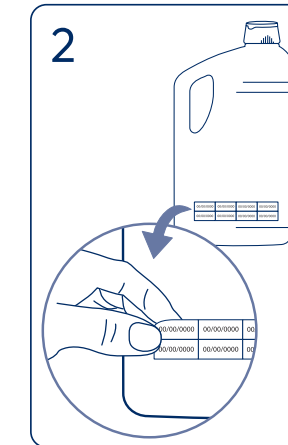

Once the 400 ml bottle has been refilled with the 5 L canister, peel of a sticker from the canister label, indicating the production batch number, and apply it to the back of the 400ml bottle



So that, the traceability of the refilled product into the bottle is ensured



Insert the bottle into the bracket

Find out more on your smartphone



5-LITRE REFILLS

Atlantis

Water bliss

5-LITRE REFILLS

Afrodite

Golden journey



Atlantis Shower gel refill  
ATL105

Atlantis Hand soap refill  
ATL106

Atlantis Shampoo refill  
ATL107

Atlantis Hair & Body  
wash refill  
ATL113

Afrodite Shower gel refill  
AFR105

Afrodite Hand soap refill  
AFR106

Afrodite Shampoo refill  
AFR107

Afrodite Hair & Body  
wash refill  
AFR113



5-LITRE REFILLS

Artemide

Nature touch

5-LITRE REFILLS

Mirage

Oriental dream



Artemide Shower gel refill  
ART105

Artemide Hand soap refill  
ART106

Artemide Shampoo refill  
ART107

Artemide Hair & Body  
wash refill  
ART113

Mirage Shower gel refill  
MIR105

Mirage Hand soap refill  
MIR106

Mirage Shampoo refill  
MIR107

Mirage Hair & Body  
wash refill  
MIR113



5-LITRE REFILLS

*Fleur de lis*

Essence provence



*Ricarica Fleur de lis*  
Shower gel  
FDL105

*Ricarica Fleur de lis*  
Hand soap  
FDL106

*Ricarica Fleur de lis*  
Shampoo  
FDL107

*Ricarica Fleur de lis*  
Hair & Body wash  
FDL113



ACQVA  
DI  
VENEZIA



*Acqua di Venezia*  
Shower gel refill  
ADV013

*Acqua di Venezia*  
Hand soap refill  
ADV014

*Acqua di Venezia*  
Shampoo refill  
ADV015

*Acqua di Venezia*  
Hair & Body wash refill  
ADV020

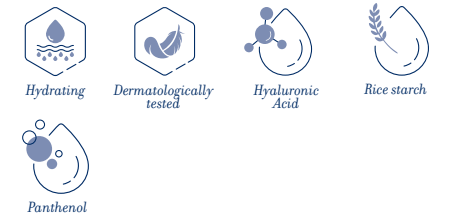
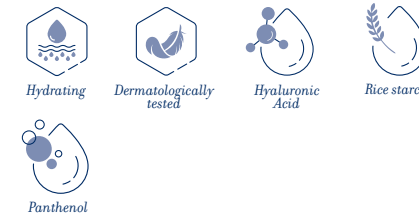
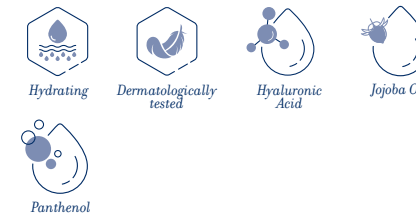
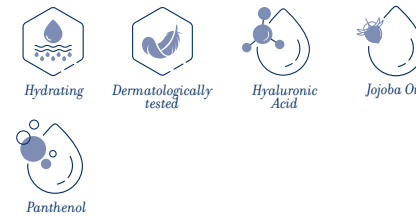



### 400 ml BOTTLE REFILLING PROCEDURE

Quick and waste-free dosing



1 Remove the cap from the can

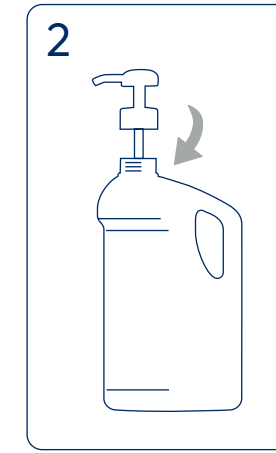

2 Insert the dispenser inside the can



3 Open the bottle, refill with the product and then close it

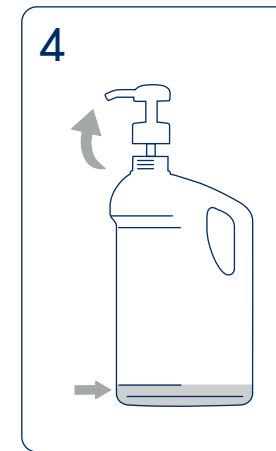

4 Once the can is empty, remove the dispenser from the can

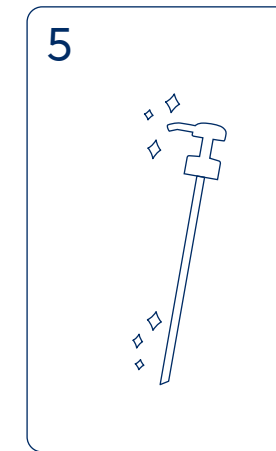

5 Sanitize the dispenser with a proper disinfectant solution

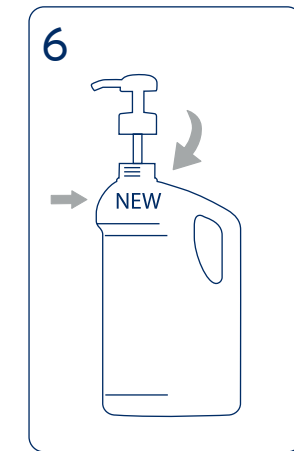

6 Insert the sanitized dispenser inside a new can

Find out more on your smartphone



## BRACKET INSTALLATION PROCEDURE

Ease of assembly and tamper-proof bottle

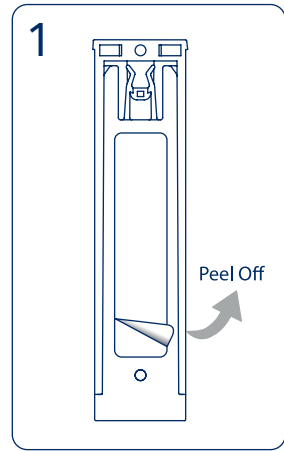

Remove the adhesive and stick the bracket on the wall

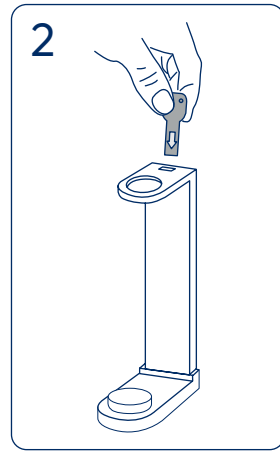

Through the appropriate key, unlock the bracket opening

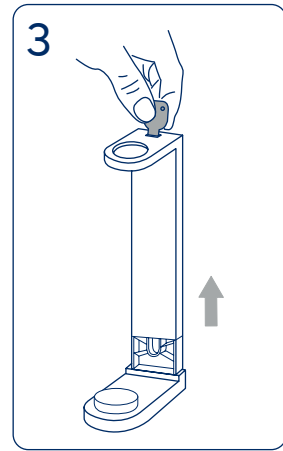

Remove the upper part of the bracket



Insert the bottle into the bracket, matching the bottle dispenser to the upper hole of the bracket

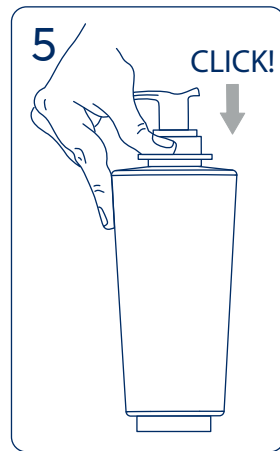

Lowers the upper movable part to make it fit into the bottle and remove the key



Find out more on your smartphone



*Arbory e Setai*  
Cartridge dispenser



# ARBORY

Arbory is an amenities line that embodies the perfect balance between formulation excellence and sustainability, thanks to its Ecolabel certification. The Arbory fragrance is a harmony of delicate and refined notes, where aquatic freshness blends with fruity sweetness and floral elegance, creating a unique sensory experience, an opportunity to celebrate nature.

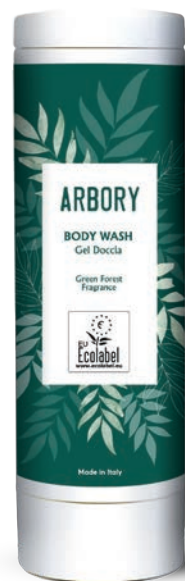

*Arbory Body wash*  
AR2030



Arbory body wash is an Ecolabel-certified body cleanser with a gentle formulation based on natural ingredients. Its fresh, aromatic fragrance leaves a pleasant scent on the skin, and its dermatologically tested formula is a guarantee of safety and quality.



Dermatologically tested



*Arbory Hand wash*  
AR1020



Arbory hand wash is an Ecolabel-certified soap for daily hand cleansing. Its gentle formula, enriched with a pleasant aromatic fragrance, leaves a sensation of softness after every wash. Dermatologically tested, it is suitable even for the most sensitive skin.



Dermatologically tested

## *Olfactory pyramid*

**Top note:** the fragrance opens with an explosion of floral and fruity notes that offer a vibrant and immediately enveloping freshness.

**Heart notes:** at the heart, violet and white flowers blend with a delicate vegetal note and a hint of apple.

**Base notes:** the base closes with the creamy softness of peach, leaving a persistent and unforgettable trail.



## *The brackets*

The bracket solution guarantees bottle inviolability and prevents any contamination for an extra security.

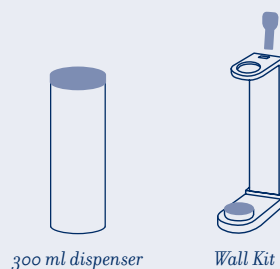

300 ml dispenser

Wall Kit

# Setai



*Setai Hair & Body wash*  
**SE2030**

Setai Shampoo and Shower Gel is a body and hair cleanser formulated to offer a gentle cleansing of the skin and scalp. The product is dermatologically tested and suitable for even the most sensitive skin.



Dermatologically tested



*Setai Hand wash*  
**SE1020**

Setai Hand Soap is a cleanser for daily hand hygiene. Its delicate, dermatologically tested formula preserves the skin's natural hydration.



Dermatologically tested



## *Olfactory pyramid*

**Top notes:** the fragrance opens with a fresh explosion of bright and clean notes, enriched by a touch of lavender and sage.

**Middle notes:** at its heart, ylang-ylang, rose and jasmine create a rich and sophisticated floral heart.

**Base notes:** the base wraps up with the smoothness of moss and vanilla, enriched by the enveloping sweetness of tonka beans.



## *The brackets*

The bracket solution guarantees bottle inviolability and prevents any contamination for an extra security.



300 ml dispenser



Wall Kit



*Monodose*



*Vegetable Soap*  
**DMHC1030**  
 DERMOMED HOTEL  
 COLLECTION



*Hair & Body Wash*  
**DMHC2040**  
 DERMOMED HOTEL  
 COLLECTION



*Hair & Body Wash*  
**DMHC2050**  
 DERMOMED HOTEL  
 COLLECTION



*Intimate Wash*  
**BE2040**  
 BEAUTY ESCAPE HOTEL  
 COURTESY SET

*Vanity Kit*



*Shower cap*  
**LCA0004**



*Vanity Kit*  
**LCA0002**



*Slippers*  
**LCA0003**



# Atlantis

## Water bliss



ATL100 ATL101 ATL102 ATL112 ATL103 ATL104 ATL111 KIT\_STAFFA

CODE	DESCRIPTION	SIZE	EAN CODE	PIECES X BOX	BOX X LAYER	BOX X PALLET
ATL100	ATLANTIS SHOWER GEL	400 ml	8050999572318	12	15	105
ATL101	ATLANTIS HAND SOAP	400 ml	8050999572325	12	15	105
ATL102	ATLANTIS SHAMPOO	400 ml	8050999572332	12	15	105
ATL112	ATLANTIS HAIR & BODY WASH	400 ml	8050999573018	12	15	105
ATL103	ATLANTIS CONDITIONER	400 ml	8050999572349	12	15	105
ATL104	ATLANTIS BODY LOTION	400 ml	8050999572356	12	15	105

CODE	DESCRIPTION	SIZE	EAN CODE	PIECES X BOX	BOX X LAYER	BOX X PALLET
ATL111	ATLANTIS AIR FRESHENER	300 ml	8050999572981	12	24	144

CODE	DESCRIPTION	ITF CODE	PIECES X BOX
KIT_STAFFA	BLACK BRACKET	18050999572766	12 brackets + 6 keys

# Afrodite

## Golden journey



AFR100 AFR101 AFR102 AFR112 AFR103 AFR104 AFR111 KIT\_STAFFA

CODE	DESCRIPTION	SIZE	EAN CODE	PIECES X BOX	BOX X LAYER	BOX X PALLET
AFR100	AFRODITE SHOWER GEL	400 ml	8050999572202	12	15	105
AFR101	AFRODITE HAND SOAP	400 ml	8050999572219	12	15	105
AFR102	AFRODITE SHAMPOO	400 ml	8050999572226	12	15	105
AFR112	AFRODITE HAIR & BODY WASH	400 ml	8050999573049	12	15	105
AFR103	AFRODITE CONDITIONER	400 ml	8050999572233	12	15	105
AFR104	AFRODITE BODY LOTION	400 ml	8050999572240	12	15	105

CODE	DESCRIPTION	SIZE	EAN CODE	PIECES X BOX	BOX X LAYER	BOX X PALLET
AFR111	AFRODITE AIR FRESHENER	300 ml	8050999572998	12	24	144

CODE	DESCRIPTION	ITF CODE	PIECES X BOX
KIT_STAFFA	BLACK BRACKET	18050999572766	12 brackets + 6 keys

# Artemide

## Nature touch



CODE	DESCRIPTION	SIZE	EAN CODE	PIECES X BOX	BOX X LAYER	BOX X PALLET
ART100	ARTEMIDE SHOWER GEL	400 ml	8050999573148	12	15	105
ART101	ARTEMIDE HAND SOAP	400 ml	8050999573155	12	15	105
ART102	ARTEMIDE SHAMPOO	400 ml	8050999573162	12	15	105
ART112	ARTEMIDE HAIR & BODY WASH	400 ml	8050999573193	12	15	105
ART103	ARTEMIDE CONDITIONER	400 ml	8050999573179	12	15	105
ART104	ARTEMIDE BODY LOTION	400 ml	8050999573186	12	15	105

CODE	DESCRIPTION	SIZE	EAN CODE	PIECES X BOX	BOX X LAYER	BOX X PALLET
ART111	ARTEMIDE AIR FRESHENER	300 ml	8050999573285	12	24	144

CODE	DESCRIPTION	ITF CODE	PIECES X BOX
KIT_STAFFA	BLACK BRACKET	18050999572766	12 brackets + 6 keys

# Mirage

## Oriental dream



CODE	DESCRIPTION	SIZE	EAN CODE	PIECES X BOX	BOX X LAYER	BOX X PALLET
MIR100	MIRAGE SHOWER GEL	400 ml	8050999573759	12	15	105
MIR101	MIRAGE HAND SOAP	400 ml	8050999573766	12	15	105
MIR102	MIRAGE SHAMPOO	400 ml	8050999573773	12	15	105
MIR112	MIRAGE HAIR & BODY WASH	400 ml	8050999573872	12	15	105
MIR103	MIRAGE CONDITIONER	400 ml	8050999573780	12	15	105
MIR104	MIRAGE BODY LOTION	400 ml	8050999573797	12	15	105

CODE	DESCRIPTION	SIZE	EAN CODE	PIECES X BOX	BOX X LAYER	BOX X PALLET
MIR111	MIRAGE AIR FRESHENER	300 ml	8050999573865	12	24	144

CODE	DESCRIPTION	ITF CODE	PIECES X BOX
KIT_STAFFA	BLACK BRACKET	18050999572766	12 brackets + 6 keys

## Fleur de lis

Essence provence



FDL100 FDL101 FDL102 FDL112 FDL103 FDL104 FDL111 KIT\_STAFFA

CODE	DESCRIPTION	SIZE	EAN CODE	PIECES X BOX	BOX X LAYER	BOX X PALLET
FDL100	FLEUR DE LIS SHOWER GEL	400 ml	8050999574084	12	15	105
FDL101	FLEUR DE LIS HAND SOAP	400 ml	8050999574091	12	15	105
FDL102	FLEUR DE LIS SHAMPOO	400 ml	8050999574107	12	15	105
FDL112	FLEUR DE LIS HAIR & BODY WASH	400 ml	8050999574206	12	15	105
FDL103	FLEUR DE LIS CONDITIONER	400 ml	8050999574114	12	15	105
FDL104	FLEUR DE LIS BODY LOTION	400 ml	8050999574121	12	15	105

CODE	DESCRIPTION	SIZE	EAN CODE	PIECES X BOX	BOX X LAYER	BOX X PALLET
FDL111	FLEUR DE LIS AIR FRESHENER	300 ml	8050999574190	12	24	144

CODE	DESCRIPTION	ITF CODE	PIECES X BOX
KIT_STAFFA	BLACK BRACKET	18050999572766	12 brackets + 6 keys

## Acqua di Venezia

Eternal heritage



ADV008 ADV009 ADV010 ADV019 ADV011 ADV012 ADV022 KIT\_STAFFA KIT\_PUMPGOLD

CODE	DESCRIPTION	SIZE	EAN CODE	PIECES X BOX	BOX X LAYER	BOX X PALLET
ADV008	ACQVA DI VENEZIA SHOWER GEL	400 ml	8050999573605	12	15	105
ADV009	ACQVA DI VENEZIA HAND SOAP	400 ml	8050999573612	12	15	105
ADV010	ACQVA DI VENEZIA SHAMPOO	400 ml	8050999573629	12	15	105
ADV019	ACQVA DI VENEZIA HAIR & BODY WASH	400 ml	8050999573711	12	15	105
ADV011	ACQVA DI VENEZIA CONDITIONER	400 ml	8050999573636	12	15	105
ADV012	ACQVA DI VENEZIA BODY LOTION	400 ml	8050999573643	12	15	105

CODE	DESCRIPTION	SIZE	EAN CODE	PIECES X BOX	BOX X LAYER	BOX X PALLET
ADV022	ACQVA DI VENEZIA AIR FRESHENER	300 ml	8050999573742	12	24	144

CODE	DESCRIPTION	ITF CODE	PIECES X BOX
KIT_STAFFA	BLACK BRACKET	18050999572766	12 brackets + 6 keys
KIT_PUMPGOLD	KIT PUMP GOLD RING	18050999574968	60 pz

## Atlantis Refill

Water bliss



CODE	DESCRIPTION	SIZE	EAN CODE	PIECES X BOX	BOX X LAYER	BOX X PALLET
ATL108	ATLANTIS SHOWER GEL	1000 ml	8050999572394	6	25	150
ATL109	ATLANTIS HAND SOAP	1000 ml	8050999572400	6	25	150
ATL110	ATLANTIS SHAMPOO	1000 ml	8050999572417	6	25	150
ATL114	ATLANTIS HAIR & BODY WASH	1000 ml	8050999573032	6	25	150
ATL105	ATLANTIS SHOWER GEL	5L /5,1 kg	8050999572363	2	18	72
ATL106	ATLANTIS HAND SOAP	5L /5,1 kg	8050999572370	2	18	72
ATL107	ATLANTIS SHAMPOO	5L /5,1 kg	8050999572387	2	18	72
ATL113	ATLANTIS HAIR & BODY WASH	5L /5,1 kg	8050999573025	2	18	72

CODE	DESCRIPTION	ITF CODE	PIECES X BOX
KIT_PUMP	DISPENSER FOR CONTAINER FILLING	18050999573008	10 dispenser

## Afrodite Refill

Golden journey



CODE	DESCRIPTION	SIZE	EAN CODE	PIECES X BOX	BOX X LAYER	BOX X PALLET
AFR108	AFRODITE SHOWER GEL	1000 ml	8050999572288	6	25	150
AFR109	AFRODITE HAND SOAP	1000 ml	8050999572295	6	25	150
AFR110	AFRODITE SHAMPOO	1000 ml	8050999572301	6	25	150
AFR114	AFRODITE HAIR & BODY WASH	1000 ml	8050999573063	6	25	150
AFR105	AFRODITE SHOWER GEL	5L /5,1 kg	8050999572257	2	18	72
AFR106	AFRODITE HAND SOAP	5L /5,1 kg	8050999572264	2	18	72
AFR107	AFRODITE SHAMPOO	5L /5,1 kg	8050999572271	2	18	72
AFR113	AFRODITE HAIR & BODY WASH	5L /5,1 kg	8050999573056	2	18	72

CODE	DESCRIPTION	ITF CODE	PIECES X BOX
KIT_PUMP	DISPENSER FOR CONTAINER FILLING	18050999573008	10 dispenser

## Artemide Refill

### Nature touch



CODE	DESCRIPTION	SIZE	EAN CODE	PIECES X BOX	BOX X LAYER	BOX X PALLET
ART108	ARTEMIDE SHOWER GEL	1000 ml	8050999573254	6	25	150
ART109	ARTEMIDE HAND SOAP	1000 ml	8050999573261	6	25	150
ART110	ARTEMIDE SHAMPOO	1000 ml	8050999573278	6	25	150
ART114	ARTEMIDE HAIR & BODY WASH	1000 ml	8050999573247	6	25	150
ART105	ARTEMIDE SHOWER GEL	5L /5,1 kg	8050999573209	2	18	72
ART106	ARTEMIDE HAND SOAP	5L /5,1 kg	8050999573216	2	18	72
ART107	ARTEMIDE SHAMPOO	5L /5,1 kg	8050999573223	2	18	72
ART113	ARTEMIDE HAIR & BODY WASH	5L /5,1 kg	8050999573230	2	18	72

CODE	DESCRIPTION	ITF CODE	PIECES X BOX
KIT_PUMP	DISPENSER FOR CONTAINER FILLING	18050999573008	10 dispenser

## Mirage Refill

### Oriental dream



CODE	DESCRIPTION	SIZE	EAN CODE	PIECES X BOX	BOX X LAYER	BOX X PALLET
MIR108	MIRAGE SHOWER GEL	1000 ml	8050999573834	6	25	150
MIR109	MIRAGE HAND SOAP	1000 ml	8050999573841	6	25	150
MIR110	MIRAGE SHAMPOO	1000 ml	8050999573858	6	25	150
MIR114	MIRAGE HAIR & BODY WASH	1000 ml	8050999573896	6	25	150
MIR105	MIRAGE SHOWER GEL	5L /5,1 kg	8050999573803	2	18	72
MIR106	MIRAGE HAND SOAP	5L /5,1 kg	8050999573810	2	18	72
MIR107	MIRAGE SHAMPOO	5L /5,1 kg	8050999573827	2	18	72
MIR113	MIRAGE HAIR & BODY WASH	5L /5,1 kg	8050999573889	2	18	72

CODE	DESCRIPTION	ITF CODE	PIECES X BOX
KIT_PUMP	DISPENSER FOR CONTAINER FILLING	18050999573008	10 dispenser

## Fleur de lis Refill

Essence provence



FDL108 FDL109 FDL110 FDL114 FDL105 FDL106 FDL107 FDL113 KIT\_PUMP

CODE	DESCRIPTION	SIZE	EAN CODE	PIECES X BOX	BOX X LAYER	BOX X PALLET
FDL108	FLEUR DE LIS SHOWER GEL	1000 ml	8050999574169	6	25	150
FDL109	FLEUR DE LIS HAND SOAP	1000 ml	8050999574176	6	25	150
FDL110	FLEUR DE LIS SHAMPOO	1000 ml	8050999574183	6	25	150
FDL114	FLEUR DE LIS HAIR & BODY WASH	1000 ml	8050999574220	6	25	150
FDL105	FLEUR DE LIS SHOWER GEL	5L /5,1 kg	8050999574138	2	18	72
FDL106	FLEUR DE LIS HAND SOAP	5L /5,1 kg	8050999574145	2	18	72
FDL107	FLEUR DE LIS SHAMPOO	5L /5,1 kg	8050999574152	2	18	72
FDL113	FLEUR DE LIS HAIR & BODY WASH	5L /5,1 kg	8050999574213	2	18	72

CODE	DESCRIPTION	ITF CODE	PIECES X BOX
KIT_PUMP	DISPENSER FOR CONTAINER FILLING	18050999573008	10 dispenser

## Acqua di Venezia Refill

Eternal Heritage



ADV016 ADV017 ADV018 ADV021 ADV013 ADV014 ADV015 ADV020 KIT\_PUMP

CODE	DESCRIPTION	SIZE	EAN CODE	PIECES X BOX	BOX X LAYER	BOX X PALLET
ADV016	ACQVA DI VENEZIA SHOWER GEL	1000 ml	8050999573681	6	25	150
ADV017	ACQVA DI VENEZIA HAND SOAP	1000 ml	8050999573698	6	25	150
ADV018	ACQVA DI VENEZIA SHAMPOO	1000 ml	8050999573704	6	25	150
ADV021	ACQVA DI VENEZIA HAIR & BODY WASH	1000 ml	8050999573735	6	25	150
ADV013	ACQVA DI VENEZIA SHOWER GEL	5L /5,1 kg	8050999573650	2	18	72
ADV014	ACQVA DI VENEZIA HAND SOAP	5L /5,1 kg	8050999573667	2	18	72
ADV015	ACQVA DI VENEZIA SHAMPOO	5L /5,1 kg	8050999573674	2	18	72
ADV020	ACQVA DI VENEZIA HAIR & BODY WASH	5L /5,1 kg	8050999573728	2	18	72

CODE	DESCRIPTION	ITF CODE	PIECES X BOX
KIT_PUMP	DISPENSER FOR CONTAINER FILLING	18050999573008	10 dispenser

## SETAI & ARBORY



AR1020



AR2030



SE1020



SE2030



DMPR008

CODE	DESCRIPTION	SIZE	EAN/ITF CODE	PIECES X BOX	BOX X LAYER	BOX X PALLET
AR1020	ARBORY HAND WASH	300 ml	8054633838761	12	24	192
AR2030	ARBORY BODY WASH	300 ml	8054633838778	12	24	192
SE1020	SETAI HAND WASH	300 ml	8050999572530	12	24	192
SE2030	SETAI HAIR&BODY WASH	300 ml	8050999572547	12	24	192
DMPR008	WHITE BRACKET	--	18050444490218	12 BRACKETS + 6 KEYS	--	--

## MONODOSE & VANITY KIT



DMHC1030



DMHC2040



DMHC2050



BE2040



LCA0004



LCA0002



LCA0003

CODE	DESCRIPTION	SIZE	EAN/ITF CODE	PIECES X BOX	BOX X LAYER	BOX X PALLET
DMHC1030	VEGETABLE SOAP	10 gr	18050999570427	1000	10	50
DMHC2040	HAIR&BODY WASH	10 ml	18050999570434	1000	5	35
DMHC2050	HAIR&BODY WASH	30 ml	18050999570441	400	6	36
BE2040	INTIMATE WASH	10 ml	18050999574418	1000	5	7
LCA0004	SHOWER CAP	--	18050999570458	1000	4	16
LCA0002	VANITY KIT	--	18054633830182	500	5	20
LCA0003	SLIPPERS	--	18054633830199	100	6	18



---

BEAUTY  
ESCAPE

---

HOTEL COURTESY SET

**Beauty Escape is a brand of Italtchimica's Professional Cosmetic Division**  
**[beauty-escape.com](http://beauty-escape.com)**

ITALCHIMICA S.r.l. Riviera Maestri del Lavoro, 10 - 35127 Padova (PD) - Italia  
Tel. +39 049 8792456 - [info@italchimica.it](mailto:info@italchimica.it)  
[italchimica.it](http://italchimica.it)



[beauty-escape.com](http://beauty-escape.com)

